

## Mix60 Installation Instructions

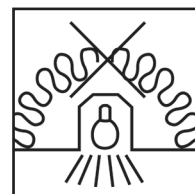
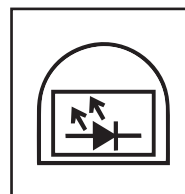
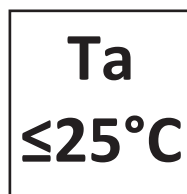
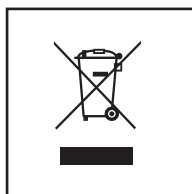
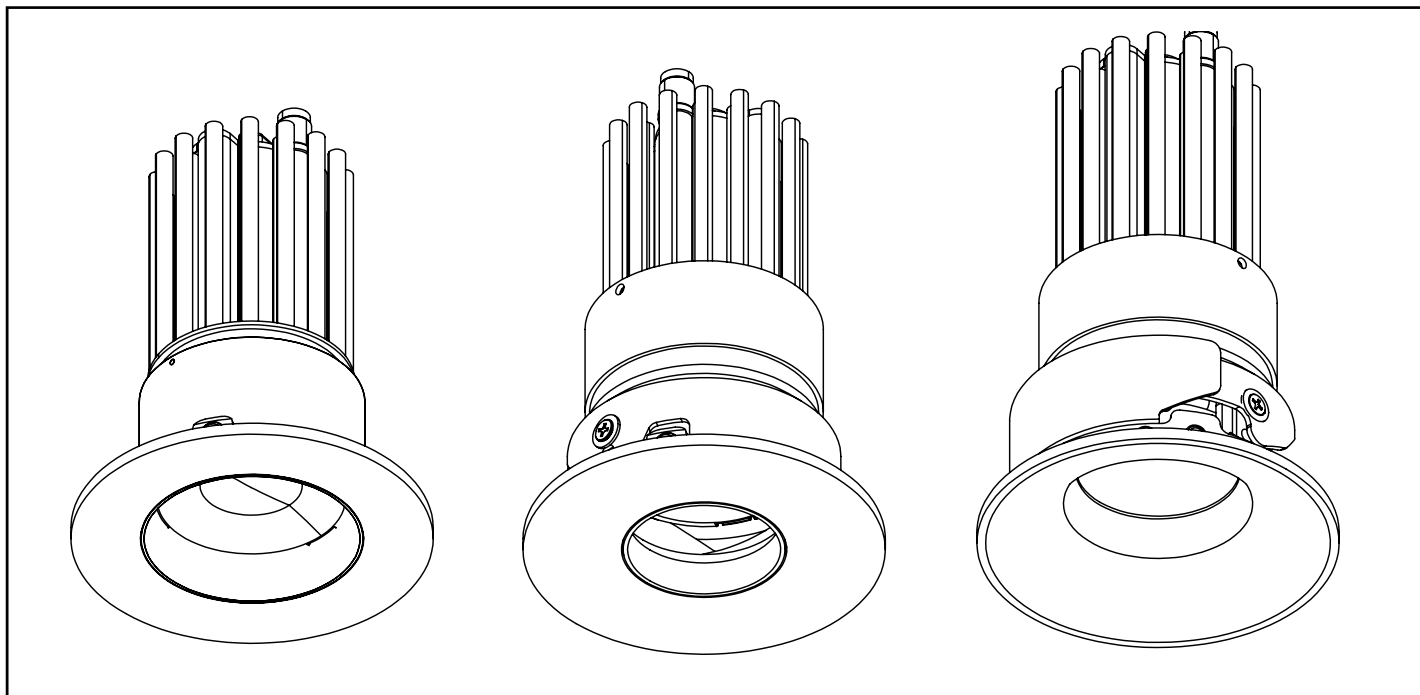

## Technical Parameters

| LED Module | Drive Current | Typ. forward volt | Mod. Power | Energy Class |
|------------|---------------|-------------------|------------|--------------|
| LED35/2    | 350mA max     | 18VDC             | 6.3W max   | F            |
| LED35/Q-HE | 150mA max     | 33VDC             | 4.95W max  | E-F          |
| LED35/Q-HO | 250mA max     | 34VDC             | 8.5W max   | E-F          |
| LED35/3-SS | 500mA max     | 11.5VDC           | 5.75W max  | G            |
| LED35/3-WD | 350mA max     | 18VDC             | 6.3W max   | F-G          |
| LED35/3-TW | 200mA max     | 38VDC             | 9.3W max   | G            |

### Note:

The recommended cable distance between the remote driver and the light source is 2 meters for most driver types. If distances greater than this are required please contact Lucent Lighting for alternative solutions.



## IMPORTANT INFORMATION

- Please read the following instructions carefully.
- Follow all national and local wiring and safety regulations.
- Connecting or disconnecting these luminaires while powered will damage the LED.
- Do not touch the LED or PCB.
- These products are designed for interior use only and only for downlighting applications.
- Optimal ambient temperature  $\leq 25^{\circ}\text{C}$ , operating range of components  $-20^{\circ}\text{C} - +40^{\circ}\text{C}$ .
- These products should only be installed by a qualified electrician.
- Lucent LED downlights light source is non user replaceable.
- Lucent LED downlights should only be replaced by a qualified person, the manufacturer or a similar qualified person.
- These products require an LED driver - DO NOT CONNECT DIRECTLY TO MAINS POWER!
- The fixing method is designed to hold the weight of the luminaire only.
- The top and bottom of the luminaire provides essential heat dissipation for the light source and must not be covered.
- The manufacturer bears no liability for damage caused by inappropriate use or application.
- Retain these instructions for future reference.

## Product information

### Mix60 Trim

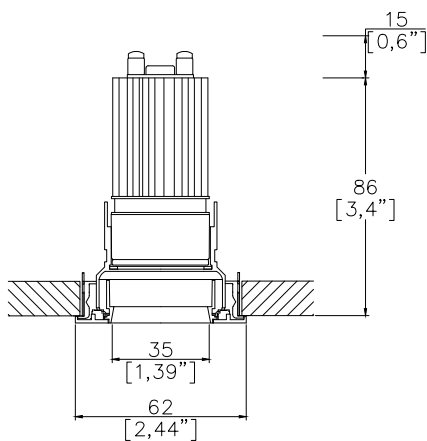

Mix60 with Trim Kit TR1

### Mix60 Trimless

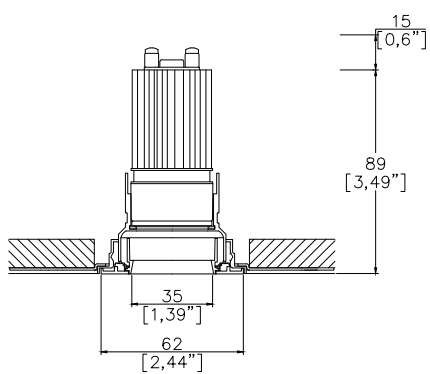

Mix60 with Trimless  
Kit TL1 (front fitting, full  
skim)

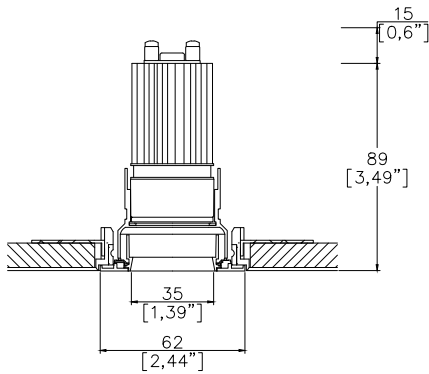

Mix60 with Trimless Kit  
TL2 (rear fitting, partial  
skim)

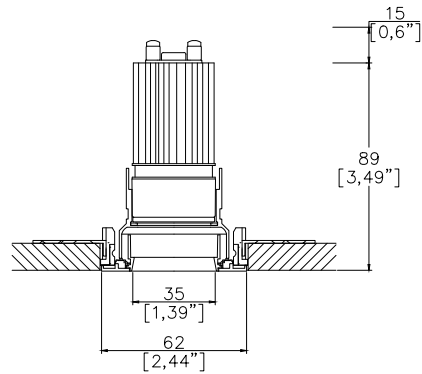

Mix60 with Trimless  
Appearance Kit TL3 (rear  
fitting, solid ceiling)

## Installation Steps



**TURN POWER OFF BEFORE INSPECTION, INSTALLATION OR REMOVAL AND PROPERLY GROUND ELECTRICAL ENCLOSURE!**

### Mix60 Trim TR1 Installation

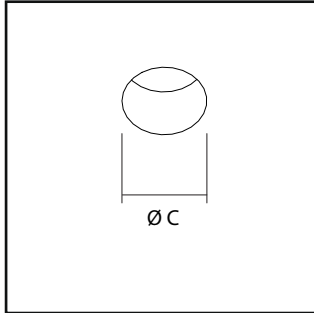

1. Create cutout C=Ø56mm

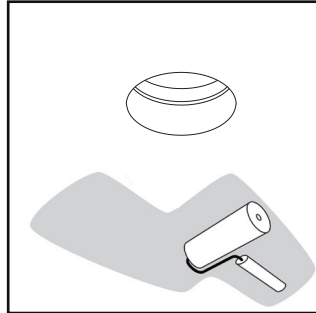

2. Finish ceiling face

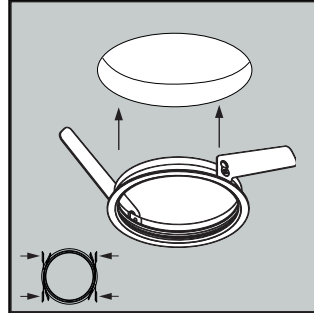

2. Trim kit installation. Fold springs back while inserting the fitting

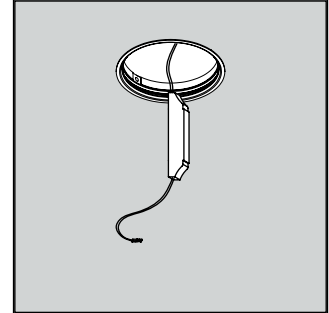

4. LED driver dropdown

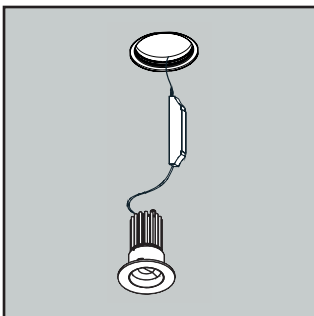

5. Fixture wiring connection

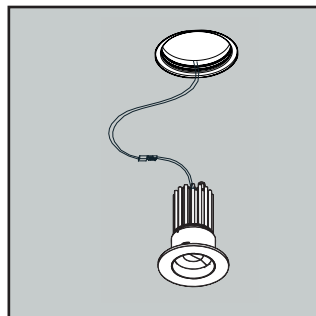

6. LED Driver re-installation

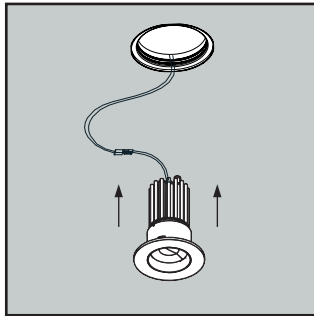

7. Insert luminaire body and ensure ball-catches are fully engaged

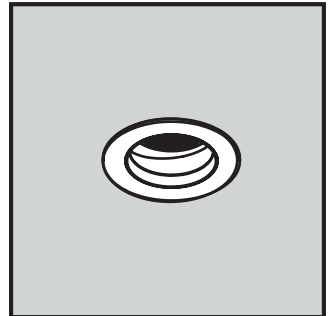

8. Adjust fitting as desired

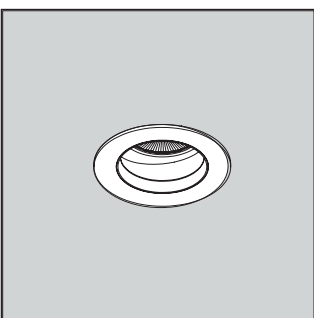

9. Finished Installation

## Installation Steps



**TURN POWER OFF BEFORE INSPECTION, INSTALLATION OR REMOVAL AND PROPERLY GROUND ELECTRICAL ENCLOSURE!**

### Mix60 Trimless Kit Full Skim Installation

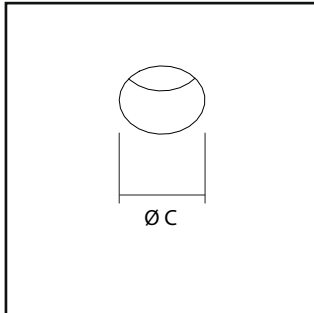

1. Create cutout C=Ø68mm

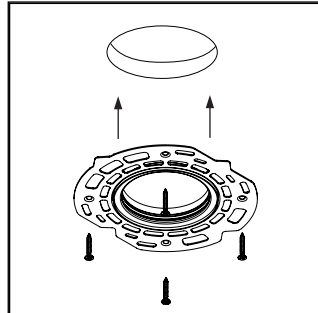

2. Trimless kit installation

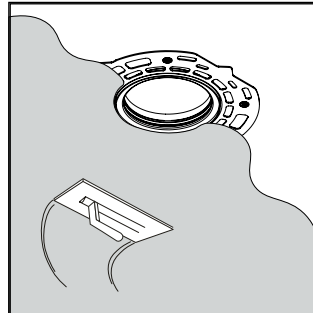

3. Finish ceiling face

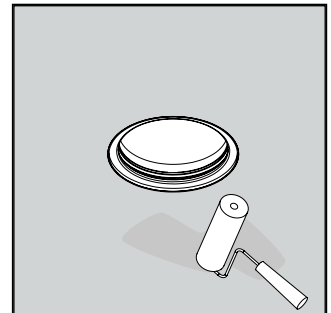

4. Paint and allow to dry fully

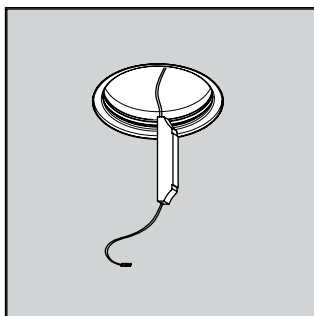

5. LED driver dropdown

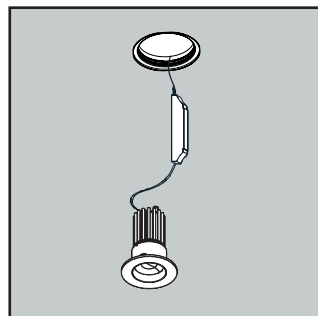

6. Fixture wiring connection

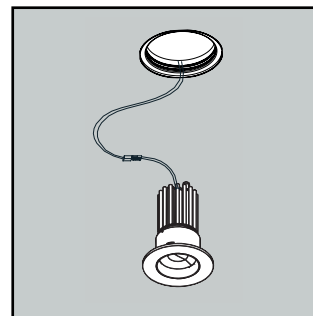

7. LED Driver re-installation

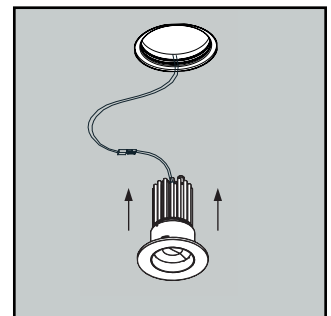

8. Insert luminaires module body and ensure ball-catches are fully engaged

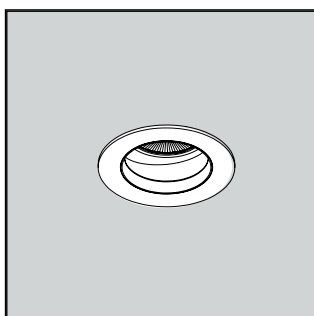

9. Adjust fitting as desired

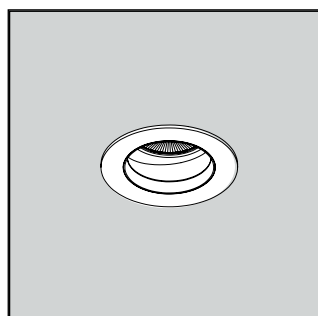

10. Finished Installation

### Kit spacing

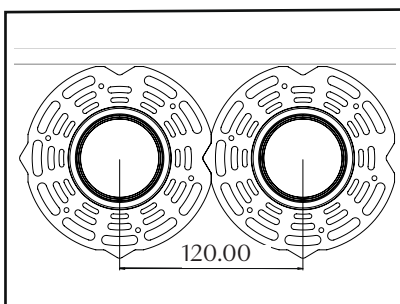

#### NOTES:

Plaster frame can be used as a guide for spacing downlights. Please note, 120mm is the minimum distance allowed between Mix60 fittings.

## Installation Steps



**TURN POWER OFF BEFORE INSPECTION, INSTALLATION OR REMOVAL AND PROPERLY GROUND ELECTRICAL ENCLOSURE!**

### Mix60 Trimless Partial Skim Installation

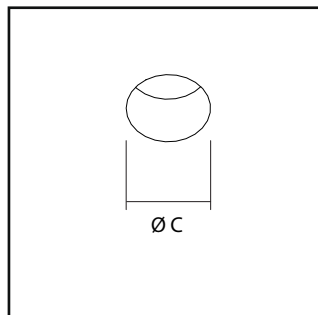

1. Create cutout C=Ø66mm

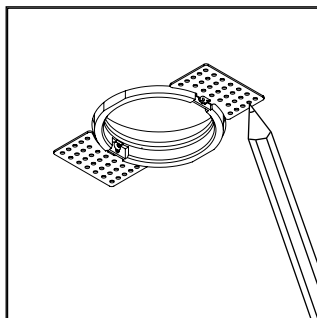

2. Position the bracket on the ceiling and mark the screw holes

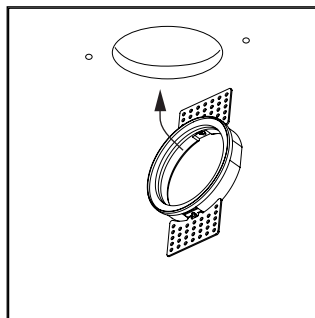

3. Insert installation kit into cutout

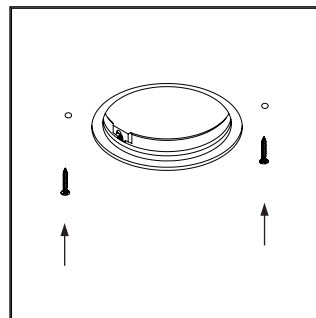

4. Secure kit through ceiling with screws

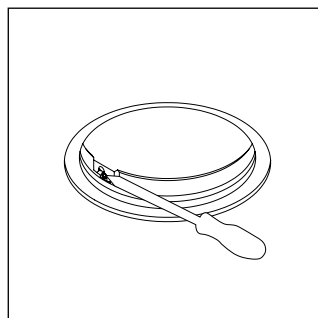

5. Adjust kit position as required

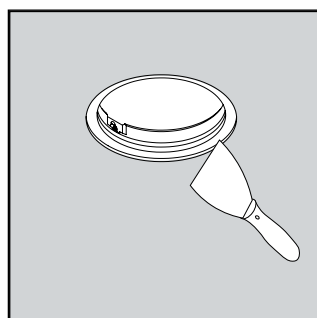

6. Skim around kit and finish ceiling face

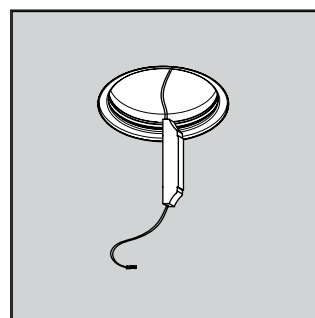

7. LED driver dropdown

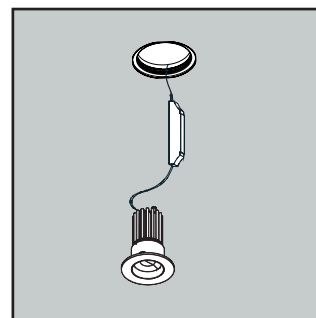

8. Fixture wiring connection

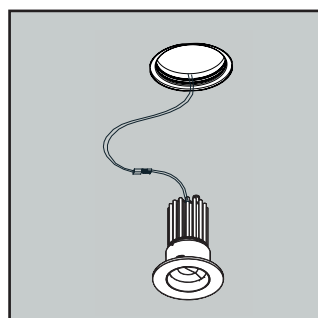

9. LED Driver re-installation

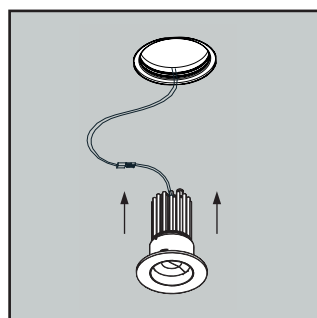

10. Insert luminaire's module body and ensure ball-catches are fully engaged

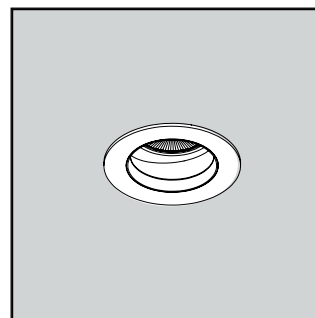

11. Adjust fitting as desired

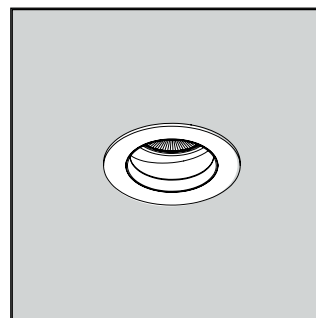

12. Finished Installation

## Installation Steps



**TURN POWER OFF BEFORE INSPECTION, INSTALLATION OR REMOVAL AND PROPERLY GROUND ELECTRICAL ENCLOSURE!**

### Mix60 Trimless Solid Ceiling Installation

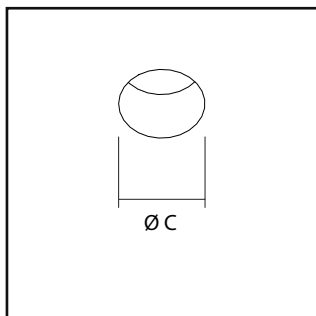

1. Create cutout C=Ø61mm

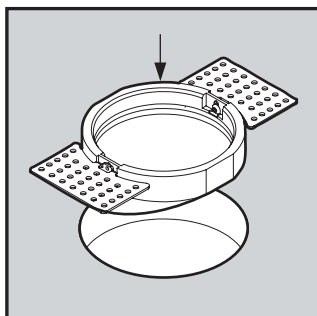

2. Insert installation kit into cutout

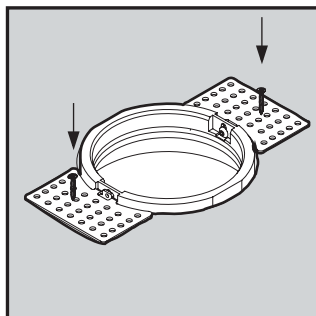

3. Secure kit to rear of ceiling with screws

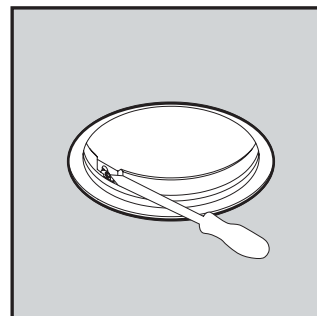

4. Adjust kit position as required

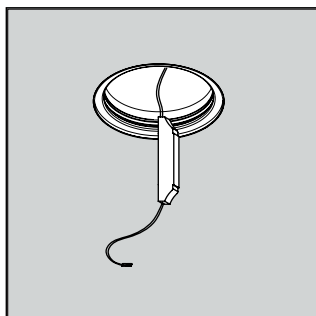

5. LED driver dropdown

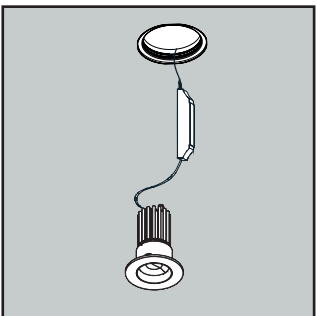

6. Fixture wiring connection

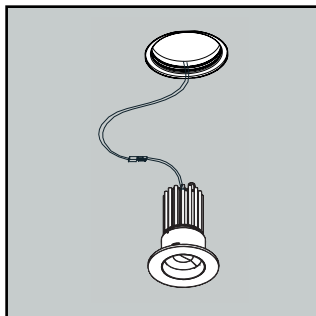

7. LED Driver re-installation

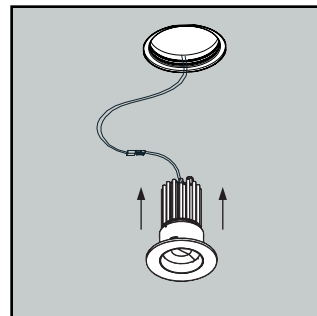

8. Insert luminaires module body and ensure ball-catches are fully engaged

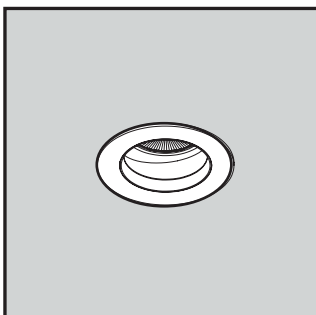

9. Adjust fitting as desired

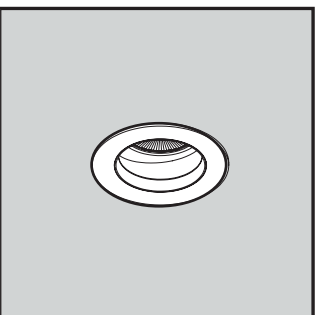

10. Finished Installation

## Bracket Spacing for Partial Skim TL2 and Solid Ceiling TL3 Kits

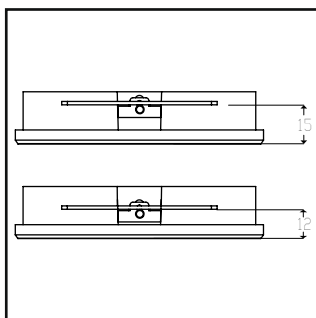

**Single Thickness Bracket:** Ceiling Thickness from 12 mm to 15 mm

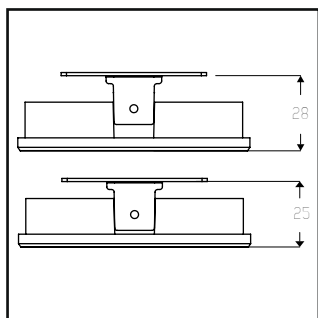

**Double Thickness Bracket:** Ceiling Thickness from 25 mm to 28 mm

**Note:** Ceiling thicknesses 15-25mm can be accommodated by using the double thickness ceiling brackets and installing a patch of the correct thickness behind the ceiling.

## Remote Driver Wiring

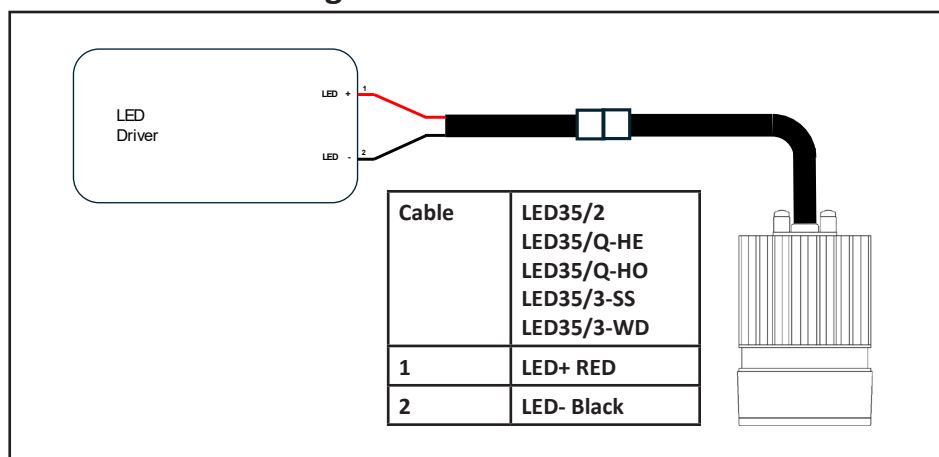

## Tuneable White Remote Driver Wiring

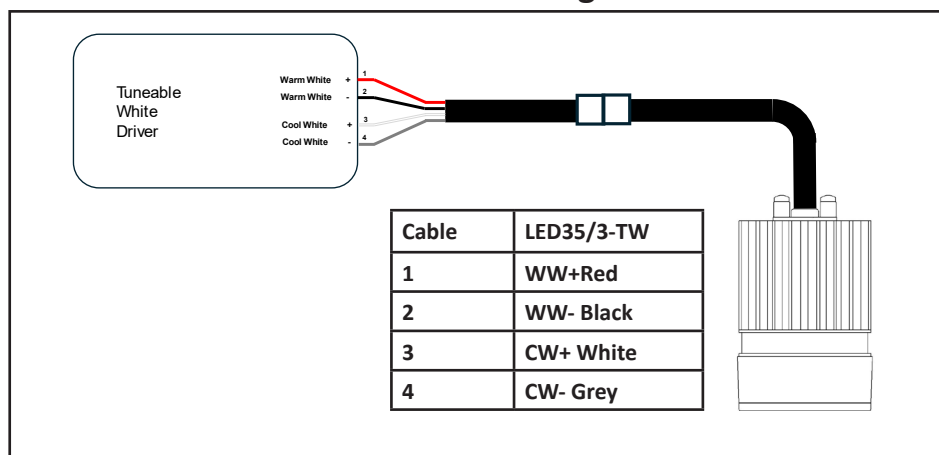

**ALL LED DRIVERS SUPPLIED BY LUCENT WILL BE PRE-WIRED WITH A LEAD THAT HAS THE CORRECT CONNECTOR TO MATCH THE LED MODULE USED. IF CONNECTORS ARE REMOVED, WARRANTY WILL BE VOID. IF THE DRIVER NEEDS TO BE REPLACED, OR CABLES EXTENDED REFER TO FOLLOWING WIRING DIAGRAMS.**



**TURN POWER OFF BEFORE INSPECTION, INSTALLATION OR REMOVAL AND PROPERLY GROUND ELECTRICAL ENCLOSURE!**

## ⚠ Servicing LED modules

LUCENT LED MODULES ARE **NON-USER** REPLACEABLE. LED MODULES SHOULD ONLY BE REPLACED BY A QUALIFIED PERSON, THE MANUFACTURER OR A SIMILAR QUALIFIED PERSON.

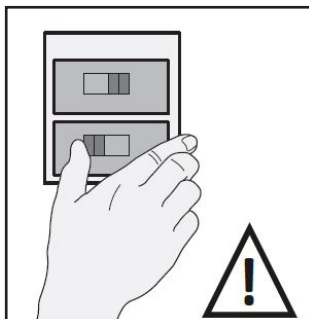

1. Switch off mains power.

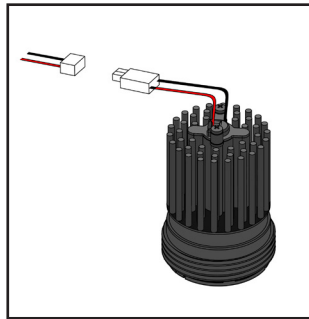

2. Disconnect LED module from the driver.

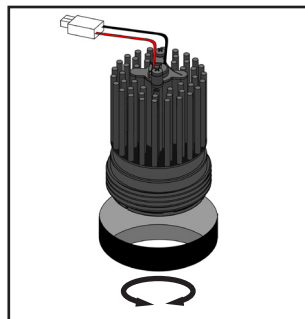

3. Turn the LED module anticlockwise to release it, then remove it.

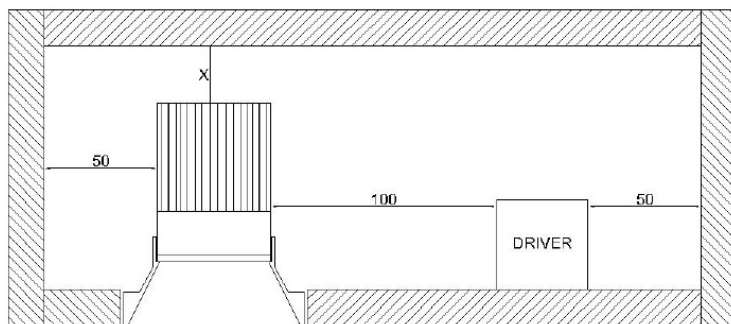

### NOTES:

Leave the minimum distance detailed above around the luminaire and driver:

For LED35 modules X= min. 15mm

For LED51 modules X= min. 25mm

For LED71 modules X= min. 25mm

\*some driver and fitting combinations may require a bigger recess depth to install driver



**TURN POWER OFF BEFORE INSPECTION, INSTALLATION OR REMOVAL AND PROPERLY GROUND ELECTRICAL ENCLOSURE!**